



HMF Radio Controller Operating Hooklifts

1021125 Edition 1 | 2021-04-25 | KM



JOAB

Table of Contents

Introduction	V
Operating The Hooklift	1
Classic Hooklift Operation	2
EcoDrive Hooklift Operation	2
Fast Operation	3
Contact Information	5

Introduction

This manual explains how to operate a hooklift using HMF's radio controller. It is only applicable to hooklifts that have a HMF crane installed. In addition, the HMF controller must be equipped with the option of controlling a hooklift. This is an extra option, it is not standard.

JOAB takes no responsibility for consequences that occur due to work carried out by non-professionals.

The specifications, constructions, and illustrations found in this manual are not binding. JOAB AB retains the right to make changes without prior notice.

Always bare in mind that it is the operator that is responsible for handling the hooklift.

© JOAB AB

Operating the Hooklift

Hooklifts can be controlled directly from HMF's radio controller. This allows the operator to operate the hooklift's basic functions only, such as tipping. The ability to control the hooklift using HMF's radio controller is not standard equipment, it must be ordered as an additional option for HMF's radio controller.

To activate the hooklift, first make sure that the PTO is ON.

For EcoDrive hooklifts and Classic - electrical hooklifts, the crane  function must also be activated in the CBW controller's interface, as shown opposite.

When activated, the green crane icon will be displayed in the user interface as shown.



For Classic - pneumatic hooklifts, the 3-mode switch, located on the dashboard, must be set to "Crane".



To operate the hooklift keep the RPM+ toggle switch (3), located on HMF's radio controller, pushed to the left, while operating the top row of control-sticks (linear-proportional-control-sticks) on the radio controller.

If the RPM+ switch is released, the crane is activated instead of the hooklift. Keep the RPM+ switch pushed left when operating the hooklift.

The top row of control-sticks (1-6), as shown opposite, are used to operate the hooklift. Refer to Table 1 for operation of Classic hooklifts. And Table 2 for operation of EcoDrive hooklifts.

In the image shown, there are six control-sticks located at the top of the controller, however, the same buttons (1-6) are also used for controllers that have eight control-sticks.

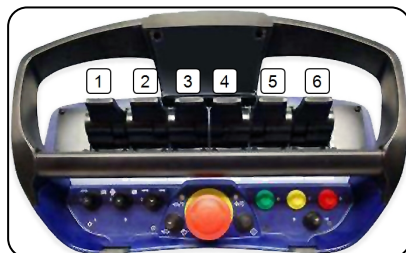
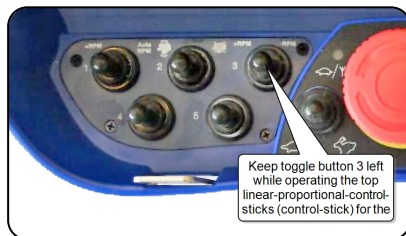

Classic Hooklift Operation

The table below lists the functions for the top control-sticks on the radio controller. This is only for Classic hooklifts.

For pneumatics hooklifts variations in Table 1 may apply depending on the crane's specification and availability of free output pins. Make sure to verify the actual operation of your hooklift with JOAB after sales department.

Table 1: Operating the hooklift - Classic hooklifts

Control-Stick	Control-Stick Up	Control-Stick Down
1	--	--
2	Hooklift - DOWN	Hooklift - UP
3	Extending section - OUT	Extending section - IN
4	--	--
5	Hydraulic lock - OPEN	Hydraulic lock - CLOSE
6 Pneumatic hooklifts only	--	Automatic flap*
6 Electrical hooklifts only	Automatic flap*	Spreader flap*

* Optional.

EcoDrive Hooklift Operation

The table below lists the functions for the top control-sticks on the radio controller. This is only for EcoDrive hooklifts.

Table 2: Operating the hooklift - EcoDrive - hooklifts

Control-Stick	Control-Stick Up	Control-Stick Down
1	--	--
2	Hooklift - DOWN	Hooklift - UP
3	Extending section - OUT	Extending section - IN
4	Folding hook post - UP**	Folding hook post - DOWN**
5	Hydraulic lock - OPEN**	Hydraulic lock - CLOSE**
6	Automatic flap*	Spreader flap*

* Optional. ** LA Models only.

Fast Operation

To activate fast operation of the hooklift, hold control-stick 3 down (extending-section -IN) while operating control-stick 2, as shown opposite.

This is only applicable to hooklifts that are equipped with fast operation. Fast operation is an optional function for the hooklifts.



Contact Information

Table 3: Contact Information

Information	Details
Adress	JOAB Försäljnings AB Östergårde Industriområde 417 29 Göteborg Sweden
Telephone	031-705 06 00
Fax	031-705 06 09
E-post	info@joab.se
Webbplats	www.joab.se